



PETTY

"A vertical Wrapping Machine For Many Needs"

PETTY 1.5

PETTY 2.2

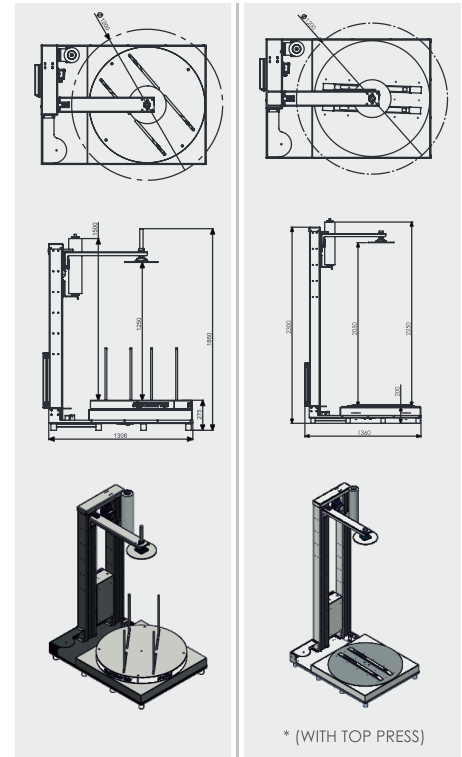

SOME PRODUCTS YOU CAN PACK WITH PETTY

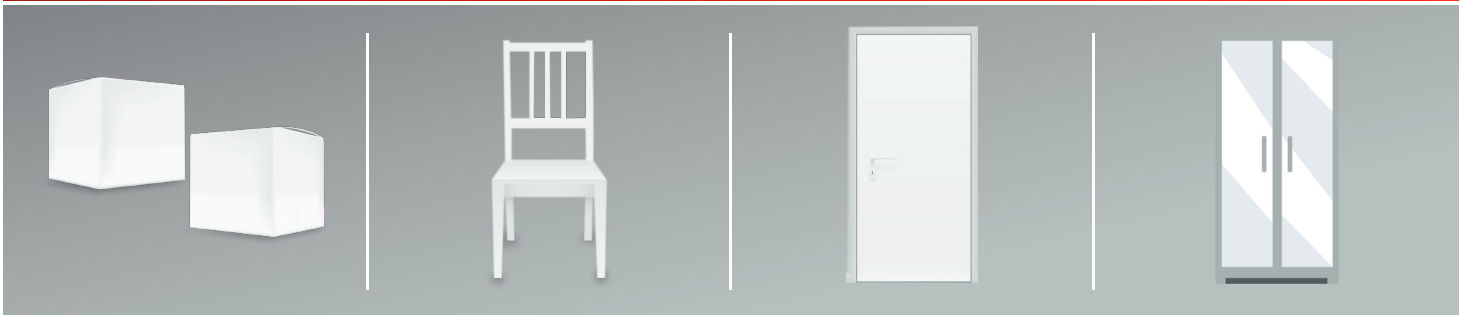

MACHINE TECHNICAL SPECIFICATIONS

| | |
|-------------------------|------------------|
| Machine Weight | 200 kg / 225 kg* |
| Plate Carrying Capacity | 120 kg |
| Power Supply Voltage | 230v |

STANDART STRETCH FILM DIMENSIONS

| | |
|--------------------|------------------------|
| Width (mm) | 500 mm max |
| Core Diameter (mm) | 50 mm |
| Thickness | 10-12-15-17-20-23 Mic. |
| Exterior Diameter | Max 150mm |

CUSTOMISE YOUR MACHINE WITH

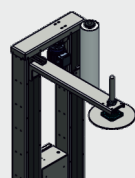

Top Pneumatic Stabilizers

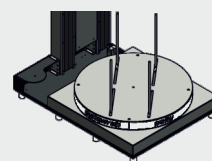

Self Holding System