

# Front Combination Light SM-C5044-RDA

Function	High and low beams
Dimension	Φ116mm*121
Material	ADC-12 matte black housing Transparent PC cover
Installation	Imbedded installed with 4-M6 bolts; holes 95±0.2mm apart
Wiring method	Open wire L=300±20mm Connector AMP-282105-1
Voltage	DC12-36V
Nominal power	44W (high beam 24W; low beam 20W)
Luminous flux	High beam 1800±300LM Low beam 1200±200LM
Color temperature	5500-6500K
IP rating	IP67
Anti-vibration	15G, sweep frequency 25-55HZ
EMC	CLAAS 3
Neutral salt spray	126 H
Operating temperature	-40°C ~ +65°C
Regulation	ECE-R149; JBT 7694-2007

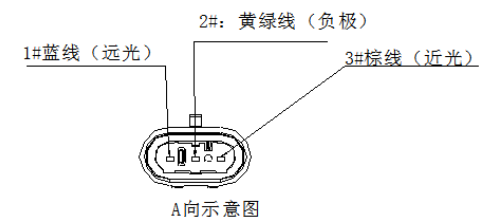
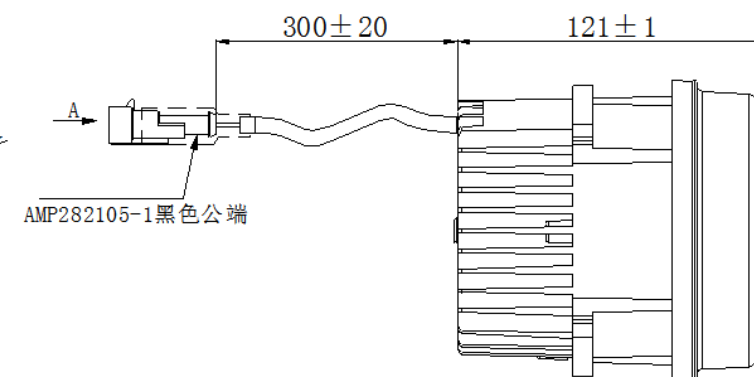
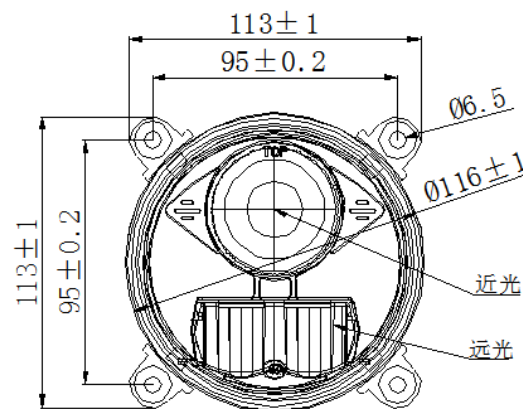
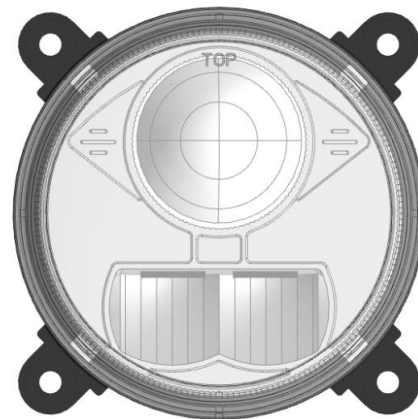

# Headlight SM-9083-RDA-L/R

Function	High beam, low beam, front cornering, front position, cornering indicator
Dimension	228*175*116 mm
Material	Housing ADC12-flat black + black PC transparent PC cover
Voltage	DC12-36 V
Nominal Power	High beam 40W; low beam 20W Front cornering and position 14W Cornering indicator 1W
Color temperature	High beam, low beam, position 5000-5500K Position 1500-1700K
Luminous flux	High beam 1800LM±300LM Low beam 1200LM±200LM; Front cornering 480LM±50LM Position 65LM±10LM
IP rating	IP67
Installation	Universal bracket with M12*35m bolts
Connector	DT04-6P
Anti-vibration	9G, sweep frequency 25-110Hz
Neutral salt spray	96H
Operating temperature	-40~ +65°C
EMC	EN50498;
Regulation	ECE-R148/R149; JBT 7694-2007
Life span	25000H

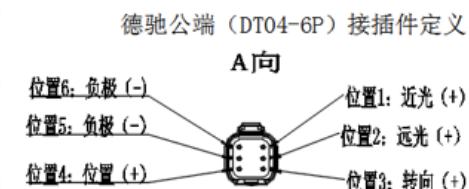
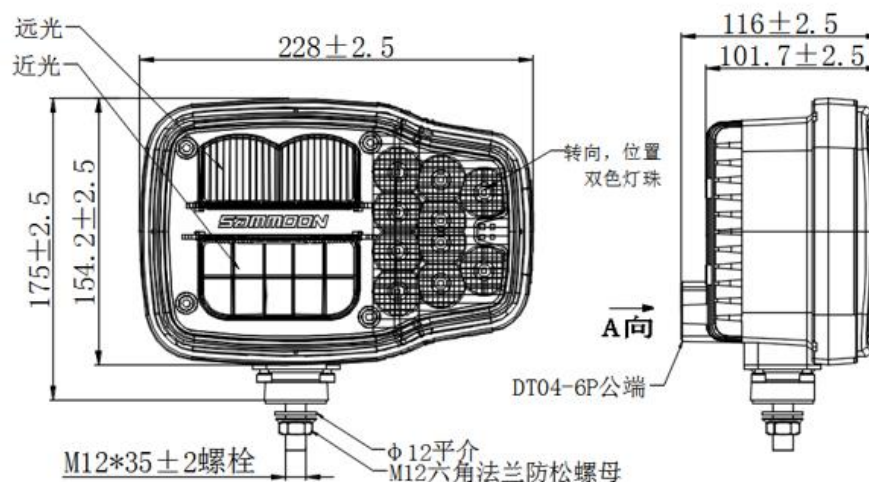

# High beam SM-6036-RHA

Function	High beam
Dimension	158*99*60 mm
Material	ADC12-flat black housing Optical grade PMMA lens Transparent PC cover
Voltage	DC 9-36V
Nominal power	36W; 18W*2PCS
Color temperature	5500-6500K
Luminous flux	1600LM±300LM
IP rating	IP67
Installation	Custom bracket with M8*16 bolts
Connector	100mm open wire with THB0436608
Anti-vibration	(1) fixed frequency 33Hz/7g (2) sweep frequency 25-60Hz/amplitude 2.5mm
Neutral salt spray	72H
Operating temperature	-40~ +65°C
EMC	EN50498
Regulation	ECE-R149
Life span	25000H

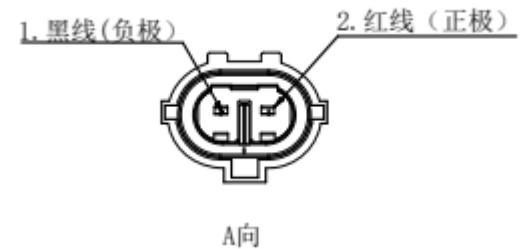
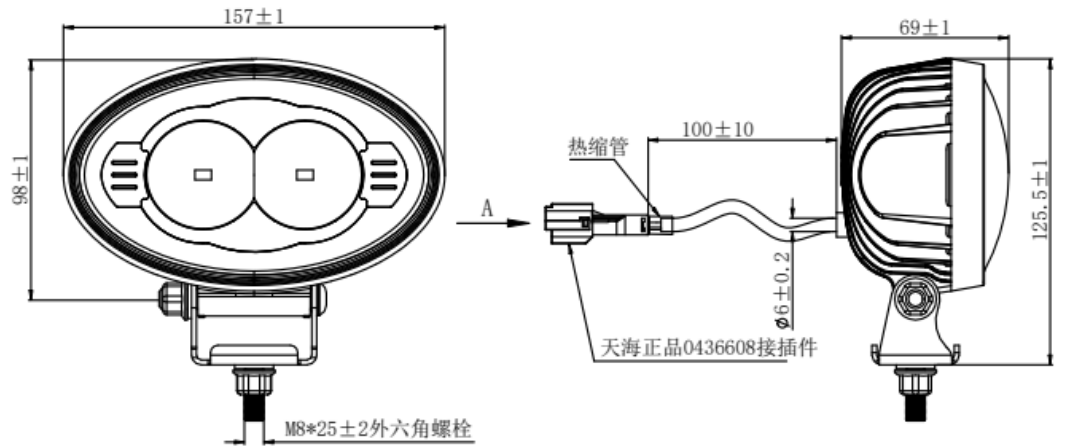

# Work Light SM-6025-SFA

Function	Flood work light
Dimension	109.8*131.4*65.3 mm
Material	ADC12-matte black housing Transparent PC cover
Voltage	DC 12-48V
Nominal power	25W; 5W*5PCS
Color temperature	5500-6500K
Luminous flux	1800LM±300LM
IP rating	IP67
Installation	Custom bracket with M10*30 bolts
Connector	(1) DT04-2P (2) customer defined connector
Anti-vibration	9G; 25-55Hz sweep frequency
Neutral salt spray	72H
Operating temperature	-40~ +85°C
EMC	EN50498
Regulation	ECE-R149
Life span	25000H

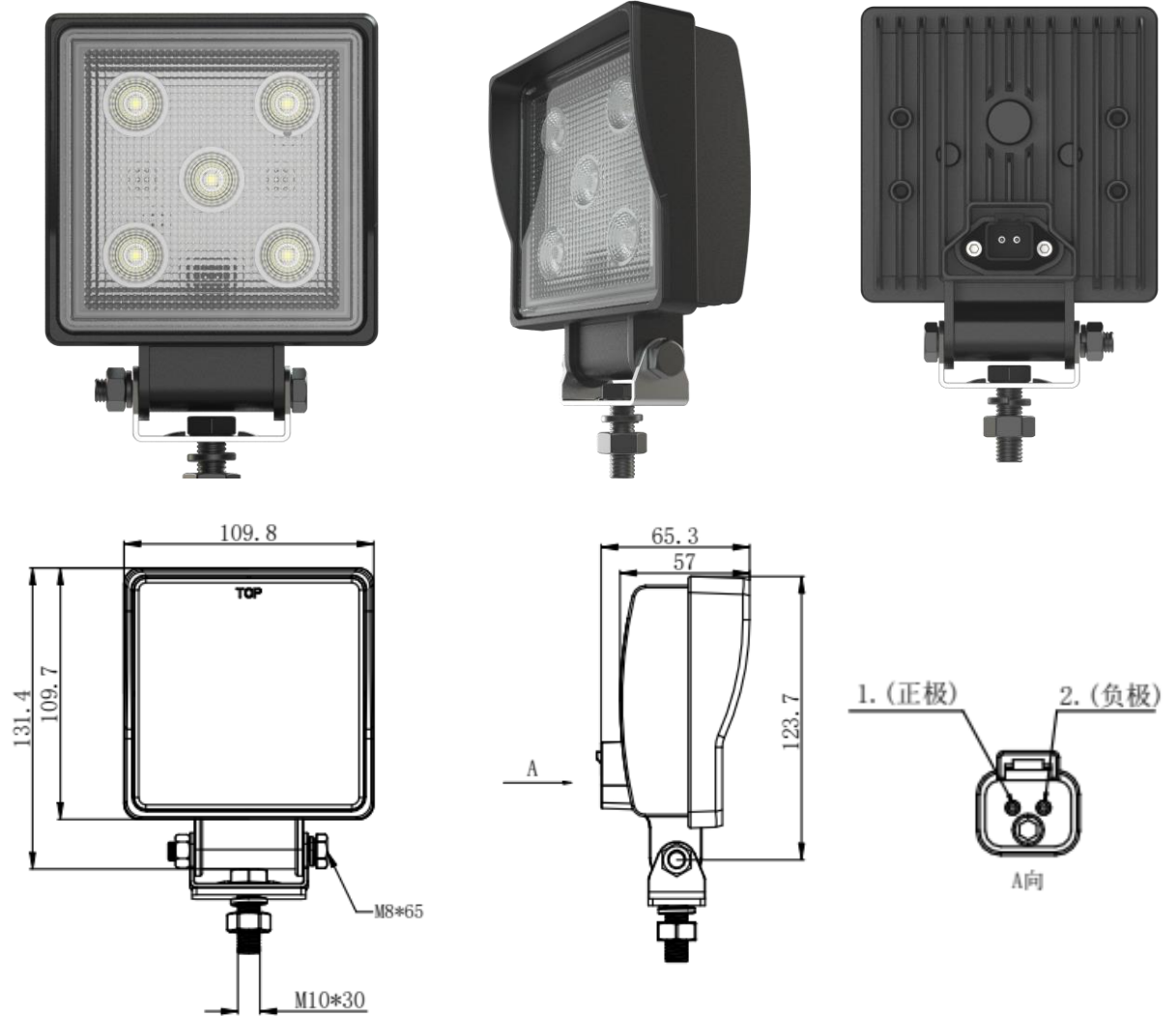

# Work Light SM-SY5027-SFE

Function	Flood work light
Dimension	123*147.7*73.5 mm
Material	ADC12-matte black housing Transparent PC cover Φ3mm-Q235A-black protective shield
Voltage	DC 12-48V
Nominal power	27W
Color temperature	5500-6500K
Luminous flux	2200LM±300LM
IP rating	IP67
Installation	Custom bracket with M10*25mm bolts
Connector	DT04-2P
Anti-vibration	30G, 25-55Hz sweep frequency
Neutral salt spray	96H
Shock impact	60G
Operating temperature	-40~ +85°C
EMC	CLASS3
Life span	25000H

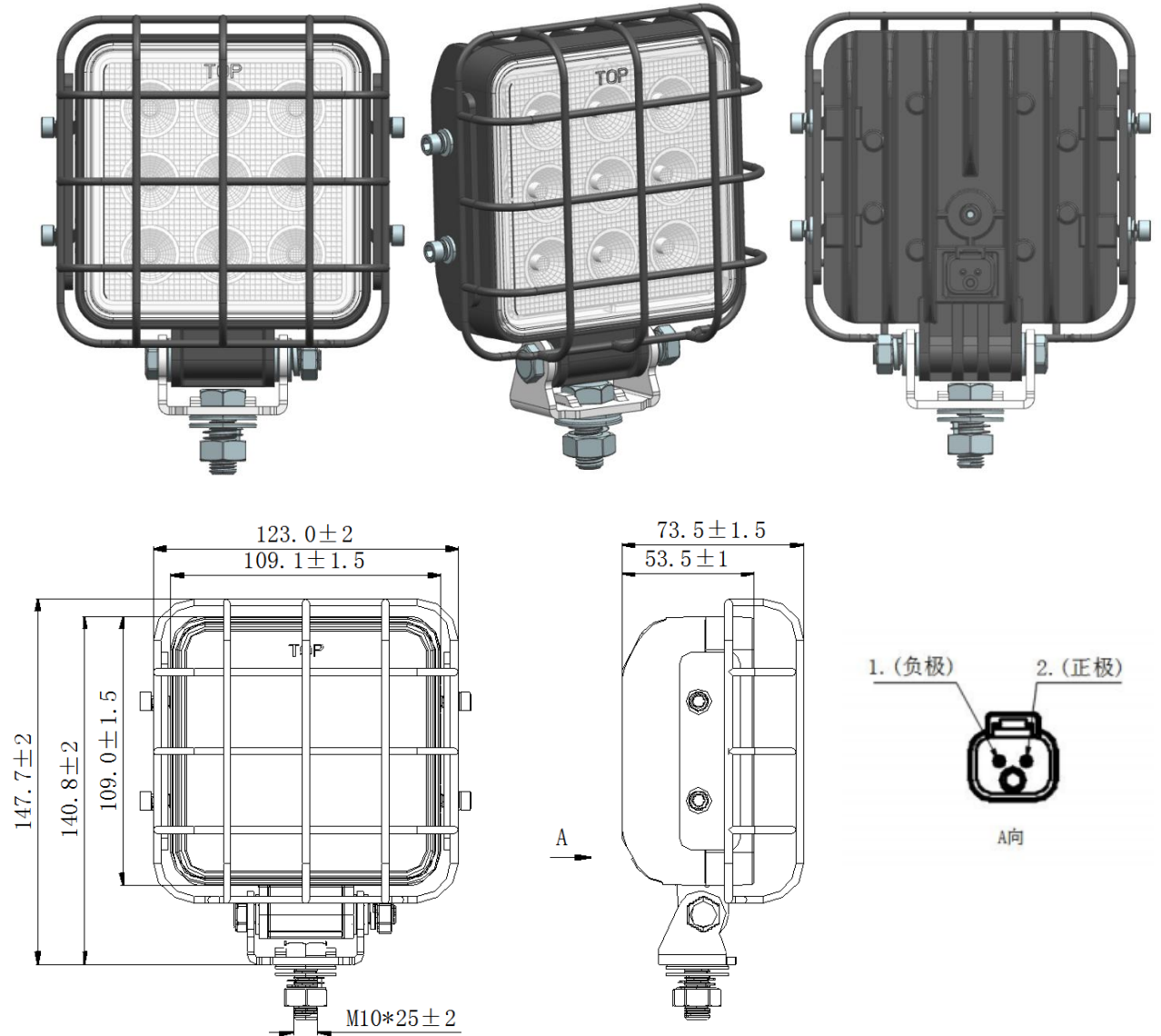

# Rear Combination Light

## SM-LG-8024E-L/R

Function	Rear cornering, brake, position, reversing, retroreflector
Dimension	192*97.5*27.8 mm
Material	Black PC housing transparent PC cover
Voltage	DC 24V
Nominal power	Rear cornering 9W Brake, position 9W Reversing 3W
Color temperature	Brake, position 950-1050K Rear cornering 1500-1700K Reversing 5500-6500K
Luminous flux	Rear cornering 170±30LM Brake 120±30LM; Position 15±5LM Reversing 220±40LM
IP rating	IP67
Installation	2-M5, bolts 55mm apart
Connector	5-core 850mm open wire with KET MG641107-5
Anti-vibration	9G; 25-110Hz sweep frequency
Neutral salt spray	72H
Shock impact	-40~ +65°C
Operating temperature	EN50498
EMC	25000H

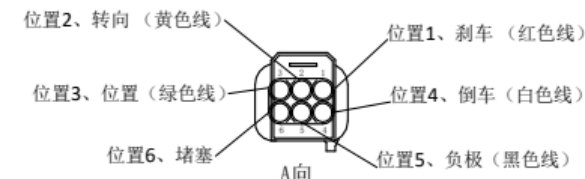
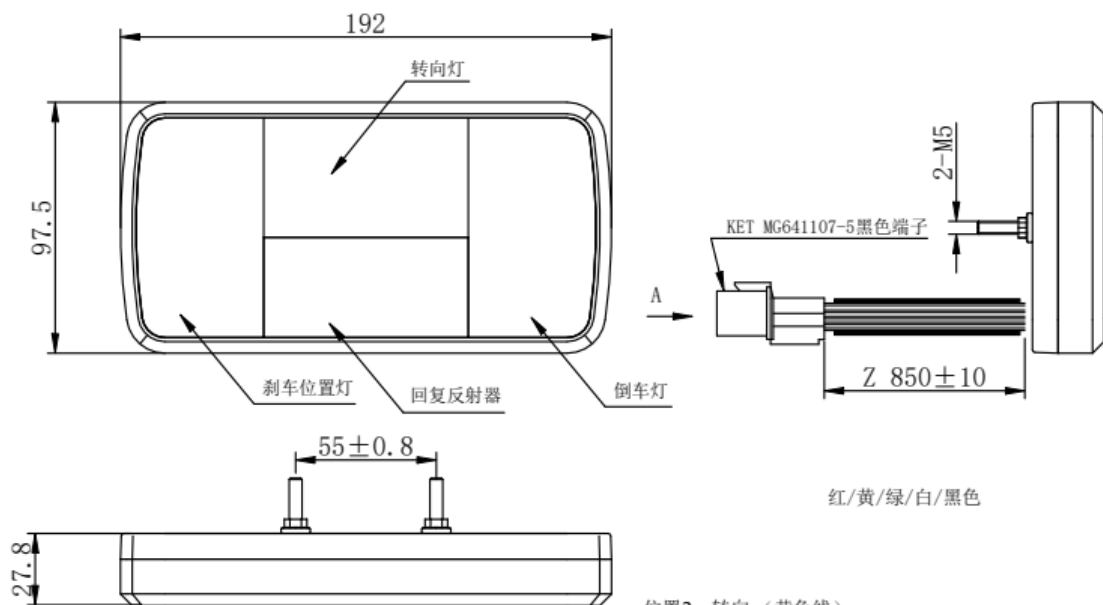

# Strobe Signal Light SM-SY2003-B

Function	Strobe signal light
Dimension	Φ40*28.5mm
Material	Amber PC cover with black rubber lining
Voltage	DC24 V
Nominal power	2W 0.5W*4PCS
Color temperature	1500-1700K
Strobe frequency	85±10/min
IP rating	IP67
Installation	M27 nylon hex nut; Holes Φ28-33mm; Installation bracket thickness 3-7mm
Connector	Corrugated tube 3*0.5mm External length 500±20mm with DT04-3P
Anti-vibration	9G; 25-110Hz sweep frequency
Operating temperature	-40~ +65°C
EMC	EN50498
Life span	25000H

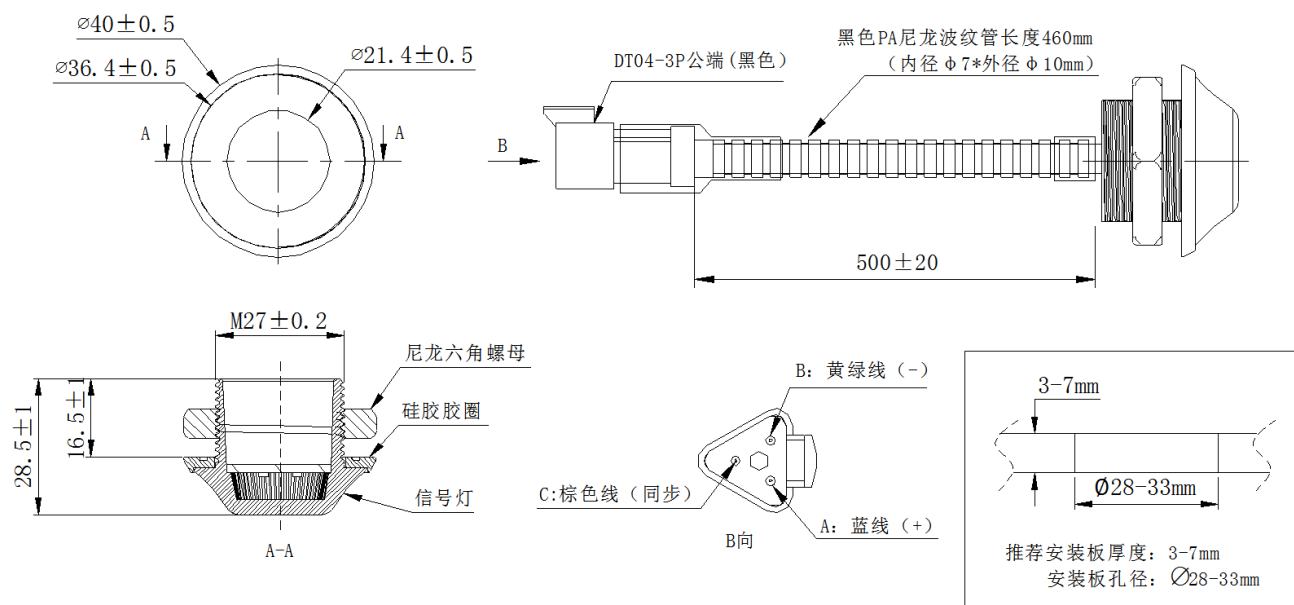
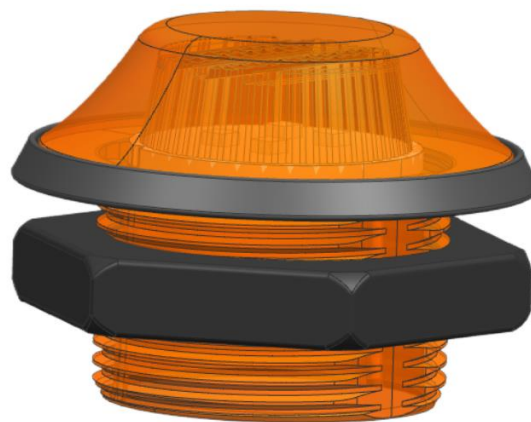

# Warning Light SM-1015-18H

Function	Audible warning light
Dimension	Φ95.7*159.5mm
Material	Amber PC cover with ADC-12 housing
Voltage	DC9-36 V
Nominal power	24W
Actual power	Light 15W; sound 3W
Frequency	Strobe 2hz; sound 1hz
Decibel	Low 95±5db; high 103±5db
Operating temperature	-40~ +65°C
IP rating	IP65
Installation	Strong bottom magnets 230N
Neutral salt spray	Light 126H; magnet 48H
Anti-vibration	10G; 25-55Hz sweep frequency
Wiring method	Spring wire 150mm + 370mm + spring wire 150mm, ITT121583-0000 connector
EMC	CLASS 3
Regulation	ECE-R65; CE
Life span	25000H

