

Urine analysis system



Any combination of 1-14 parameters



Sejoy Biomedical Co., Ltd.

Add : Area C, Building 2, No.365, Wuzhou Road, Yuhang Economic Development Zone, Hangzhou City, 311100, Zhejiang, China



poct@sejoy.com



+86 571-81957782/+86 18868123757



www.sejoy.com

Urine Analyzer URA-101

- External Output: Standard USB output port, and can be networked with PC
- Testing Speed: 60 times/h for once testing, 120 times/h for continuous testing.
- Language: English
- Test Principle: Principle of reflection measurement of ultra-high brightness cold light source
- Testing Items: WBC, NIT, URO, PRO, pH, BLD, SG, VC, KET, BIL, GLU, MALB, CRE, CA, ACR
- Light Wavelength: All of visible light wavelengths
- Power: $\leq 20W$
- Environment Condition: 0-30°C, RH<80%
- Net Weight: 238g
- Vol: 135*80*30mm



Convenient



1000 tests



72 hours Standby



continuously
>120 strips/hour



Accurate



Thermal printer
inside, 1000 tests

Urine Analyzer URA-102

- Testing Items: WBC, NIT, URO, PRO, pH, BLD, SG, VC, KET, BIL, GLU, MALB, CRE, CA, ACR
- Data Memory: 1000 test results
- Language: English
- Testing Principle: super-high luminosity cold light source reflection testing principle
- Data Communication Interface Baud Rate: 9600bps
- Environment Condition: 0-40°C, RH< 85%
- Power: AC 220V, 50-60Hz, $\leq 60W$
- Fuse Wire Specification: 250V 2A
- Net Weight: 4Kg
- Size: 355*300*145mm

Reagent Strips for Urinalysis

Features

- Any combination of 1-14 parameters
- Analytical sensitivity comparable to market leaders
- High quality color chart ensures accurate visual reading
- Compatible for visual and analyzer reading
- Anti-VC interference ability



Specification

Operation environment	20°C-30°C (The best test temperature is 23°C-27°C), relative humidity≤80%
Storage environment	2-30°C (At room temperature or refrigerated)
Validity of opening	3 months
Storage validity	24 months

Easy testing procedure

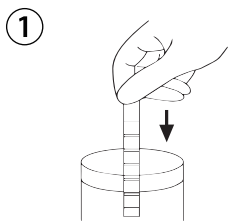

① Completely immerse the edge of the strip in fresh urine

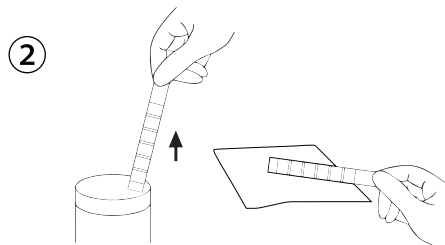

② Immediately remove the strip and wipe off excess urine

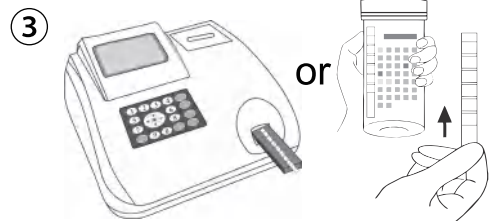

③ Interpret results by urine analyzer or visual reading

- | | | | |
|--------------|---------------|------------------|-----------|
| Urobilinogen | Blood | Leukocytes | Ascorbate |
| Bilirubin | Protein | Glucose | Calcium |
| Ketone | Micro Albumin | Specific Gravity | |
| Creatinine | Nitrite | pH | |

