

SİPARİŞ KODU ORDER CODE	F	AÇIKLAMA / DESCRIPTION	LxWxH	Ad Pcs
			kg	Ad Pcs
104-01-67	301 302	Hector Baza üst 3 Pimli <i>Hector Plinth Top Section with 3 pins</i>	39,5 x 39,5 x 35,5	—
			15,800 kg	400
104-01-66	301 302	Hector Baza üst bağlantı <i>Hector Plinth Top Section</i>	40 x 30 x 32	—
			5,450 kg	400
104-01-65	301 302	Hector Baza üst Dübelli <i>Hector Plinth Top Section with spreading dowels</i>	40 x 40 x 32	—
			6,900 kg	400

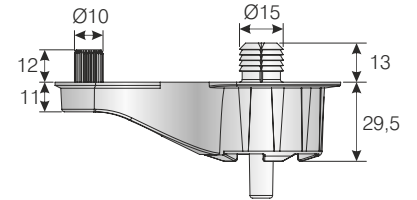

104-01-67

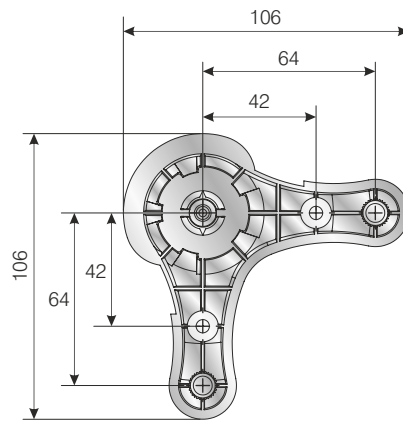

104-01-66



104-01-65

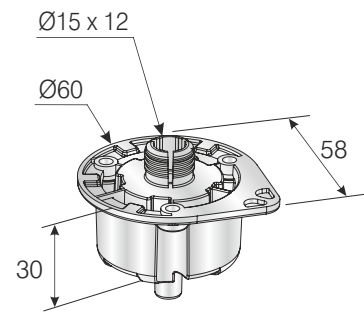
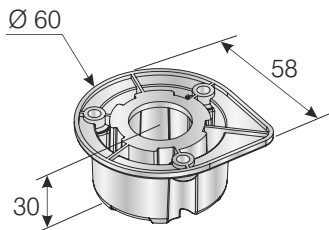

SİPARİŞ KODU ORDER CODE	F	AÇIKLAMA / DESCRIPTION	↕	H	LxWxH	Ad Pcs
					kg	Ad Pcs
104-01-62	301, 302	Hector Baza boru 100mm <i>Hector Foot and shaft section 100 mm</i>	-5 +25 mm	76-105 mm	40 x 40 x 50	—
					10,720 kg	400
104-01-63		Hector Baza boru 120mm <i>Hector Foot and shaft section 120mm</i>	-5 +25 mm	96-125 mm	59 x 39 x 40	—
					12.000 kg	400
104-01-64		Hector Baza boru 150mm <i>Hector Foot and shaft section 150mm</i>	-5 +25 mm	126-145 mm	60 x 40 x 52	—
					13,400 kg	400
104-01-91		Baza pingo tapası <i>Foot plug</i>	—	—	30 x 30	—
					0,760 kg	400



104-01-62



104-01-63



104-01-64

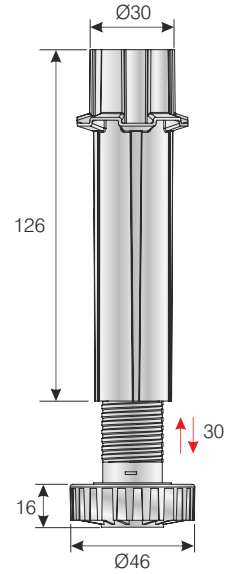
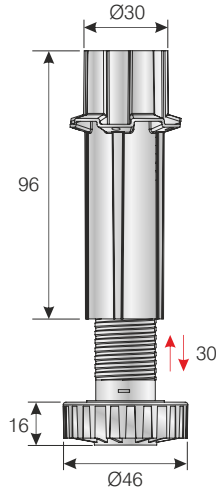
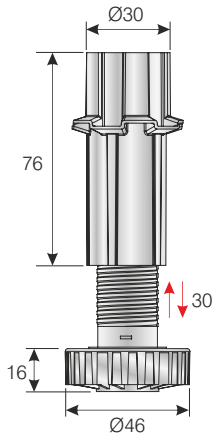

Baza Üst Bağlantılar / Plinth top section

SİPARİŞ KODU ORDER CODE	F	AÇIKLAMA / DESCRIPTION	LxWxH	Ad Pcs
			kg	Ad Pcs
104-92-02	301	M10 Plastik tespit vidası Plinth top section Screw M10 plastic	29 x 19 x 13	—
			1,000 kg	400
104-01-31		Baza üst bağlantı Top section	39,5 x 39,5 x 31,5	—
			7,110 kg	400
104-01-32	301, 302	Baza üst bağlantı tespit vidalı Top section for M10 screw fixing	39,5 x 39,5 x 31,5	—
			8,060 kg	400
104-01-33		Baza üst bağlantı ekonomik Top section economic	40 x 30 x 25	—
			4,360 kg	400



104-01-33

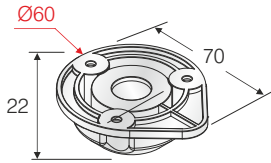

104-01-31

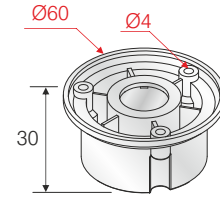

104-92-02

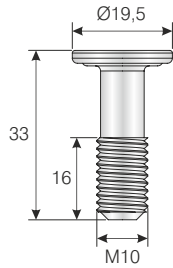

M10 Plastik tespit vidası
(104-01-32 kodlu Baza üst bağlantı tespit vidalı için kullanılır.)

104-92-02 Plastic
Screw M10 using for fixing
of Top section 104-01-32



104-01-32

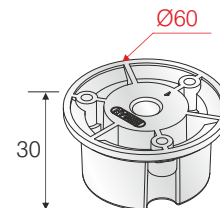

Baza Üst Bağlantılar / Plinth top section

SİPARİŞ KODU ORDER CODE	F	AÇIKLAMA / DESCRIPTION	LxWxH	Ad Pcs
			kg	Ad Pcs
104-01-34	301	Baza üst bağlantı kare Dübelli Top section rectangle press fit with dowels	59 x 39 x 39,5	—
		12,490 kg	400	
104-01-30	302	Baza üst bağlantı kare Top section rectangle press fit	39,5 x 39,5 x 43	—
		11,960 kg	400	
104-01-45		Profilli Baza Üst Top Section for Aluminium Plinth Profile	40 x 40 x 43	—
104-01-35		Baza üst bağlantı dübelli Top section with spreading dowel	39,5 x 39,5 x 31,5	—
		7,170 kg	400	



104-01-34

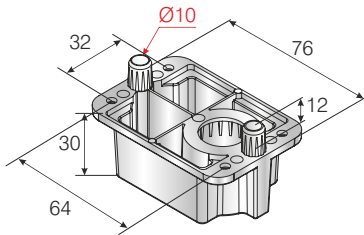

104-01-30

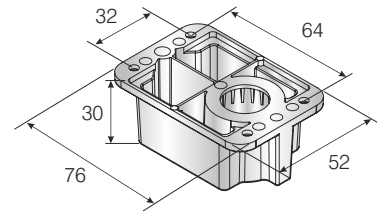

104-01-21 Kodlu 80mm Baza Boru bu ürün ile kullanılamaz.

104-21-01 Foot and shaft section 80mm is not used with this product



104-01-45

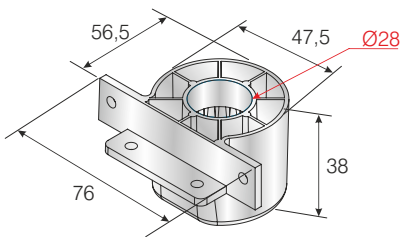

104-01-35

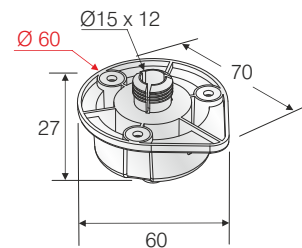

Baza Boruları / Feet

SİPARİŞ KODU ORDER CODE	F	AÇIKLAMA / DESCRIPTION	↑↓	H	LxWxH	Ad Pcs
					kg	Ad Pcs
104-01-21	301, 302	Baza boru 80mm Foot and shaft section 80mm	-5 +25 mm	75-105 mm	39,5 x 39,5 x 43	—
					8,850 kg	400
104-01-22		Baza boru 100mm Foot and shaft section 100mm	-5 +25 mm	95-125 mm	39,5 x 39,5 x 50	—
					9,510 kg	400
104-01-23		Baza boru 120mm Foot and shaft section 120mm	-5 +25 mm	115-145 mm	59 x 39 x 39,5	—
				10,980 kg	400	
104-01-24	Baza boru 150mm Foot and shaft section 150mm	-5 +25 mm	145-175 mm	59 x 39 x 51,5	—	
				12,540 kg	400	
104-01-91		Baza pingo tapası Foot plug	—	—	30 x 30	—
					0,760 kg	400

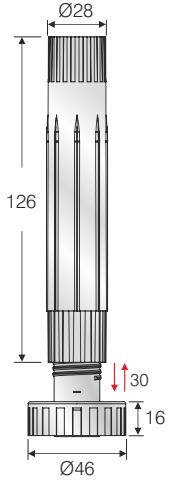

104-01-24

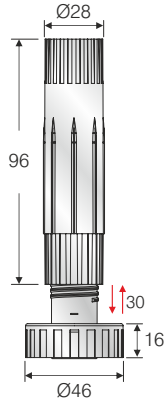

104-01-23

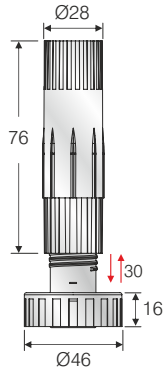

104-01-22

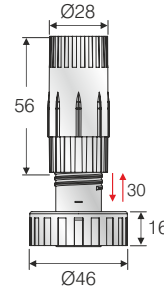

104-01-21

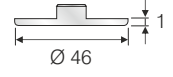

104-01-91



104-01-24

150 mm
Ayak / Foot

(145 - 175 mm)



104-01-23

120 mm
Ayak / Foot

(115 - 145 mm)



104-01-22

100 mm
Ayak / Foot

(95 - 125 mm)

104-01-35 Kodlu Dübelli
Baza Üst bu ürün ile kullanılmaz.

104-01-35 Top section with spreading
dowel is not used with this product



104-01-21

80 mm
Ayak / Foot

(75 - 105 mm)



104-01-91

Baza pingo tapası
Foot plug

(Ø46 mm)

SİPARİŞ KODU ORDER CODE	F	AÇIKLAMA / DESCRIPTION	↕	H	LxWxH	Ad Pcs
					kg	Ad Pcs
104-01-25	301, 302	Baza ayak 100-150mm (2 parçalı) Foot and shaft section all-in-one 100-150mm	-5 +50 mm	100-150 mm	59 x 39 x 52,5	—
					14,260 kg	400
104-01-28		Baza boru 100-150mm (Boru + Pingo) Foot and shaft section dismountable 100-150mm (Foot + Tube)	-5 +50 mm	100-150 mm	39,5 x 39,5 x 50	—
					10,000 kg	400



104-01-25

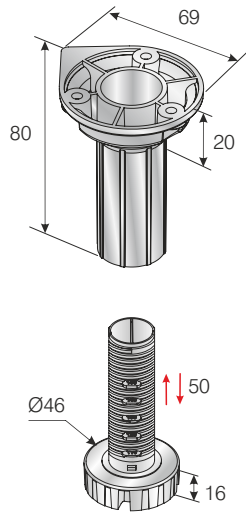

Baza Ayak (2 parçalı)
Foot and top section all-in-one
(100 - 150 mm)



104-01-28

Baza Boru (3 parçalı)
Foot and top section dismountable
(100 - 150 mm)

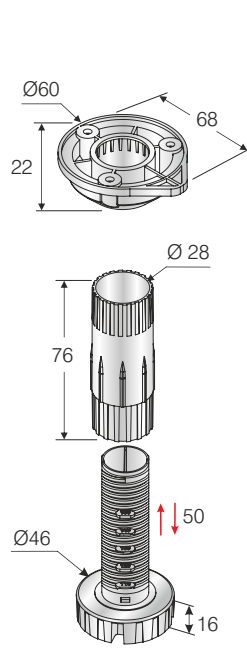

Boru + Pingo
Foot + Tube