

# GARNET XS4

CNC Profile Machining Center (4 Axis)

Automation by  
**FANUC**

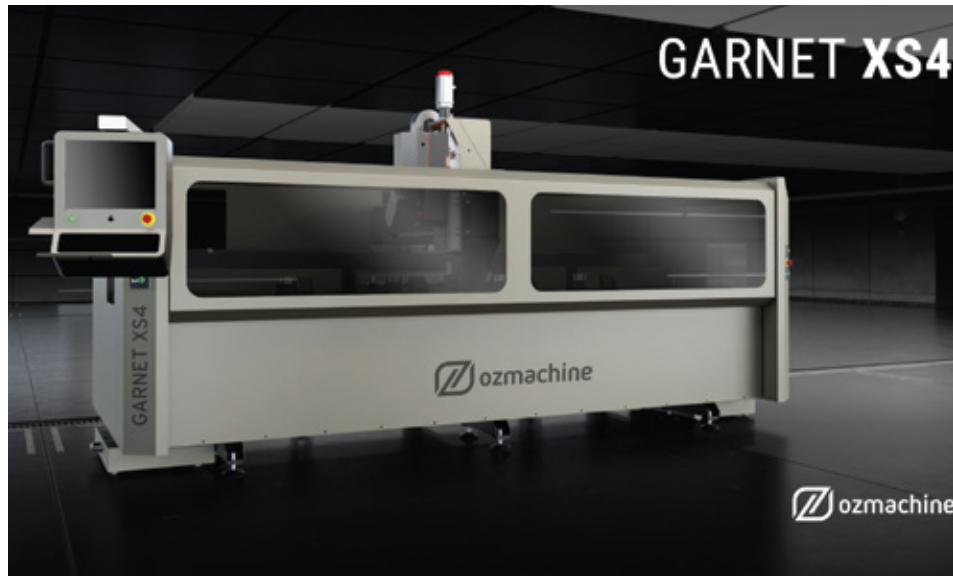

The 4-axis CNC machining center, GARNET XS 4, boasts a versatile spindle that tackles a wide range of materials, including aluminum, PVC, light alloys, and even steel. With its ability to operate between -90° and +90°, the **GARNET XS 4** tackles profiles of various sizes. This all-in-one powerhouse streamlines milling, water channel opening, punching, marking, and end milling for diverse materials, excelling at both standard and non-standard operations. An impressive working area of 340 mm x 255 mm further enhances user experience by enabling efficient processing.

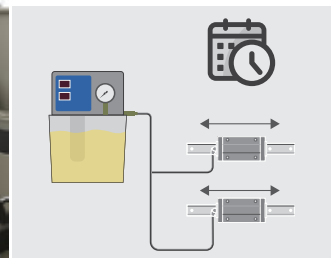

By focusing on providing convenient solutions for customers, and combining power and precision, GARNET XS4 lets the processing capacity be only limited by the users imagination, thanks to the 5.6 kW spindle motor with automatic tool replacement feature.

Thanks to its built-in automatic magazine with capacity for 8 tools, GARNET XS4 saves time when switching to different operations. The GARNET XS4, which positions its clamps fully automatically using the X-axis, completely takes on the user's workload.

Double-Linear Guide bridge systems have are more rigid and durable compared to single-Linear Guide bridge systems. Reduced vibration and allows for more precise processing of the profiles.

Maintenance of transmission elements is accomplished by the automatic lubrication system which is offered as an optional feature increasing the service life for accuracy in processes. Capacity may be varied for processing of non-standard profiles with on demand optimization of size and number of clamps.

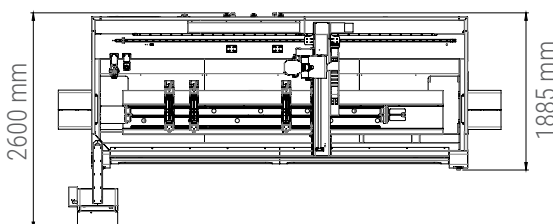
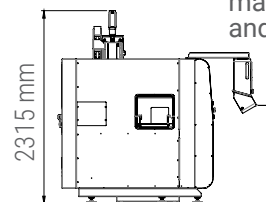
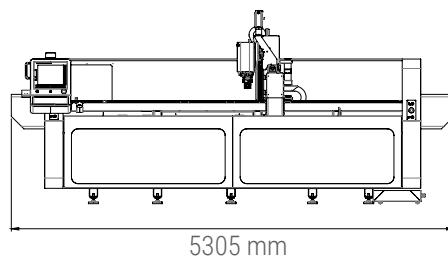

# GARNET XS4

CNC Profile Machining Center (4 Axis)

## MACHINING LENGTHS

X Axis (Longitudinal)	3000 mm
Y Axis (Lateral)	340 mm
Z Axis (Vertical)	255 mm
A Axis (Head processing angles)	-90° / +90°

## POSITIONING SPEED

X Axis (Longitudinal)	90 m/min
Y Axis (Lateral)	60 m/min
Z Axis (Vertical)	20 m/min
A Axis (Rotational Movement)	166° /sec

## AIR

Pressure	6-8 Bar
----------	---------

## ELECTRICAL

Max. Power	8 kW
Voltage	400V 3P, N, PE AC
Frequency	50-60 Hz

## SPINDLE

Max. Power	5.6 kW
Maximum rotation speed	20.000 r.p.m
Tool holder	HSK F50
Cooling type	Liquid

## TOOL STORAGE

Automatic Linear Type Tools Magazine	●
Maximum tool storage system number	8
Maximum saw blade diameter in to the storage system	150 mm
Automatic Tools Measuring	●

## SCREW-CUTTING CAPACITY

M8 - with compressed tapping head	○
-----------------------------------	---

## PROFILE POSITIONING

Right and left pneumatic profile reference alignment	●
--	---

## CONTROL UNIT

Industrial PC - Touch Screen	15"
Barcode reader	●
Camquix CAM program	●
CadXtract CAD-CAM Production program	○

## OPERATIONAL AREA

Clamps, standard pcs	4
Clamps, maximum pcs	6
Automatic clamp positioning with the X-axis	●
Automatic lubrication in processing area	●
Cabinet providing protection in processing zone	●
B&R automation system	○
Automatic lubrication system	○
FESTO pneumatic system	○
Side tunnels	●

● Standard ○ Optional