

INSTRUCTION MANUAL

Smart password lock 103-1-CS Series



To ensure management and decoding permissions, install the APP and register the decoding lock as soon as possible!

CE/FCC/PSE/ROHS/SGS

Contents

1. Battery Installation

- 1.1 The first using
- 1.2 Replacing battery

2. Operating Instruction

- 2.1 unlocking
- 2.2 locking
- 2.3 Change code

3. Other Instruction

- 3.1 Acousto-optic notification
- 3.2 Technical Parameters
- 3.3 APP

Figure 1

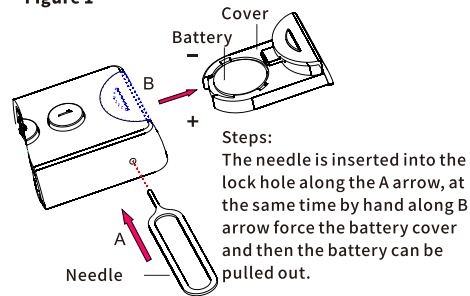

1. Battery Instruction

1.1 The first use

Each new lock has a built-in new battery at factory and white insulation slices to cut off the connection in order to prevent power consumption during transportation. When first using it, only need to pull out the white insulation slices and hear the sound of smart lock, which means it starts working.

1.2 Replacing battery

When the battery is in low power or shows no power/battery, remove the battery cover as figure 1 and insert new battery to work (Figure 1 shows). Corresponding marks will guide user to avoid wrongly placing battery.

2. Operation Instruction

2.1 unlocking :

“user code + OK” Rotate the knob to unlock

Factory default code is 1, user input inputs "1 + OK" and hear a long sound, rotate the knob to unlock the lock within 3 seconds. User can change the code according to below 2.3.

2.2 Locking:

Anticlockwise rotate the knob to the exact position to lock

Any time anticlockwise rotate the knob to the exact position, it can be locked.

2.3 Change code:

“old code + OK + OK + new code(1-12 digits) + OK”

Input “Old code + OK + OK + New code + OK” and you hear a long sound, which means the new code is set successfully. Example: change the default code from 1 to 123, input “1+ OK + OK + 123 + OK” and when you hear a long sound, the new code will come into effect.

2.4 Forgot password:

Scan code to register WeChat miniprograms, with decoding service.

3. Other Instruction

3.1 Acousto-optic notification

NO.	Name	Sound notification	Explanation
1	Button	Ti short sound	The “keypress” is effective
2	Unlocking change	Ti long sound	Operation correct unlocking /change code successfully
4	Error	Ti Ti two sounds	Operation error, input failure
5	Low power	Ti Ti Ti three sound	Low power, replace a new battery
6	Alarm	Ti alarm sounds	3 times wrong input will cause alarm sounds for 60 seconds

Note 1: Replacing battery when the battery is in low power, during the low power condition, user still can unlock for 500 times.

Note 2: 3 times input the code incorrectly will cause alarm sounds for 60 seconds, input the correct code can cancel the alarm.

3.2 Technical Parameters

Working voltage	DC2.3-3.3V
Battery SPEC	Cr1225
Standby current	≤2uA
MAX.current	≤ 5mA and time of duration ≤ 35ms
Battery life	1-2year unlock 30-50 times one day
Operating Temp	-20°C to 70°C
Relative humidity	20% to 80%
Material	zinc alloy/ABS
Diameter of mounting	apply to diameter 16mm-20mm
Thickness of plank	Steel: 0.5-12mm Timber: 0.5-22mm
Certification	CE/FCC/PSE/ROHS/SGS/SST

3.3 APP

3.3.1 Combination lock APP Self-help management

Please scan the following qr code, go to download and register the member according to the relevant prompts to realize the registration /management of the password lock.

The detailed help will be explained in the APP.



APP